

VERSION	CHANGE CONTENT	DATE
V01	FIRST ISSUE	2015.07.10

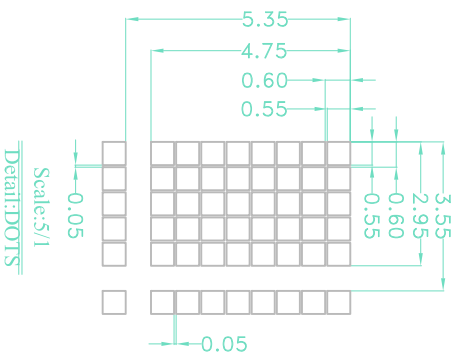
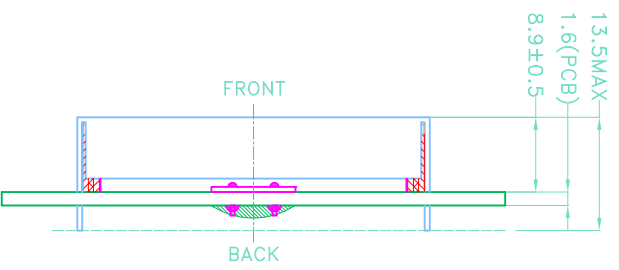
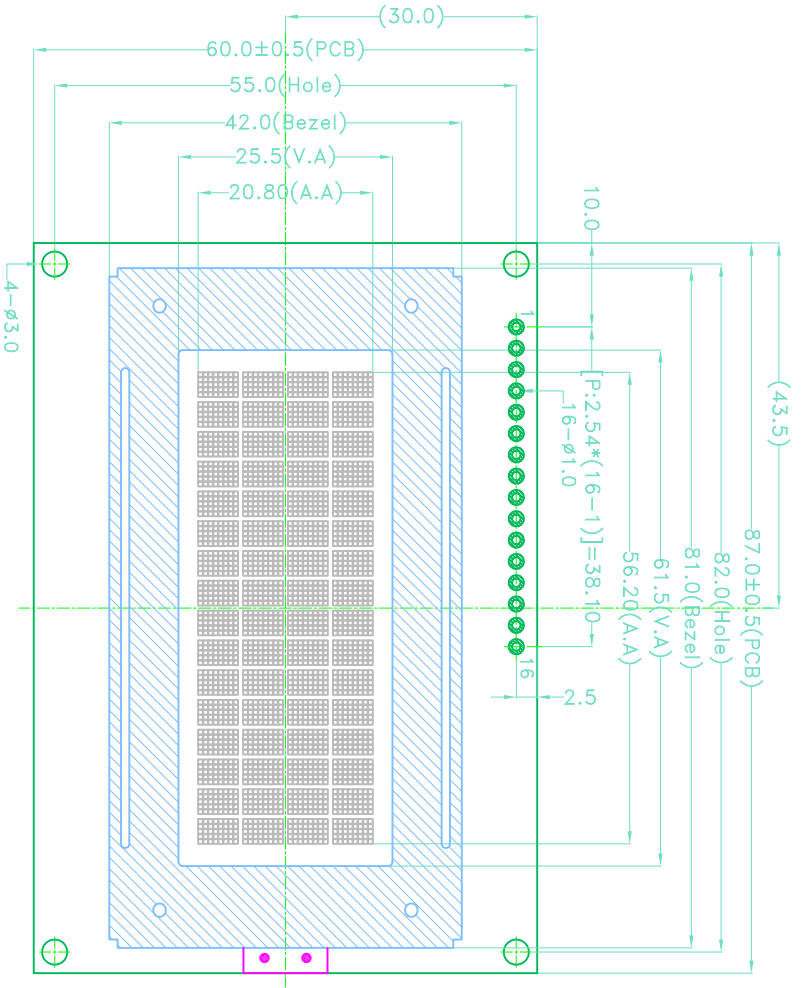

PCB PIN ASSIGNMENT:

1	VSS	9	DB2
2	VDD	10	DB3
3	V0	11	DB4
4	RS	12	DB5
5	R/W	13	DB6
6	E	14	DB7
7	DB0	15	LED+
8	DB1	16	LED-

SPECIFICATIONS

1. DISPLAY TYPE:STN Y/G/STN BLUE/STN Positive/Negative
2. DISPLAY RESOLUTION: 16*04 CHARACTER
3. LCD DRIVING VOLTAGE:4.7V
4. LOGIC VOLTAGE:5.0 V±0.2V
5. VIEWING DIRECTION:6 O'CLOCK
6. OPERATING TEMP:0°C -- +50°C
7. STORAGE TEMP:-10°C -- +60°C
8. LCD CONTROLLER/DRIVE:SPIC780D1 (Or Compatible)
9. DRIVE MODE:1/16 DUTY, 1/5 BIAS
10. BACKLIGHT:SIDE LED BACKLIGHT
11. REMARK:

PCB PIN ASSIGNMENT:

1	VSS	9	D2
2	VDD	10	D3
3	V0	11	D4
4	RS	12	D5
5	R/W	13	D6
6	E	14	D7
7	D0	15	LED+
8	D1	16	LED-

DESCRIPTION:

ThingWell Electronics

SCALE: 1:1		
SHEET: 1 OF 1		
PROJECTION	LCM NUMBER	W1604A
UNIT: mm	DRAWING VERSION	V01
APP:	CHK:	DWN:
DATE:	DATE:	DATE:

MECHAICAL TOLERANCE:x±0.3,x.xx±0.2