

VERSION	CHANGE CONTENT	DATE
V01	FIRST ISSUE	2015.07.10

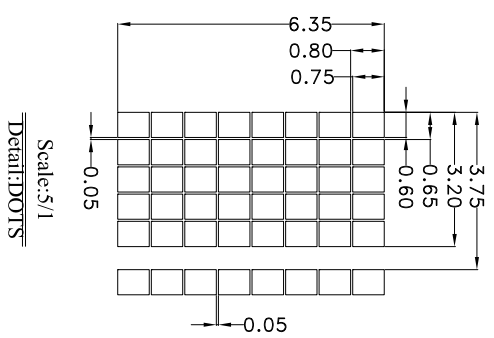
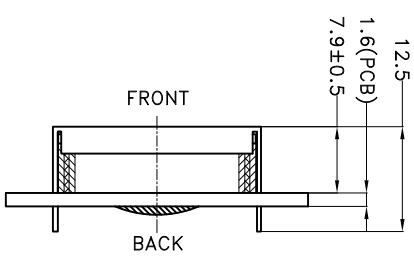
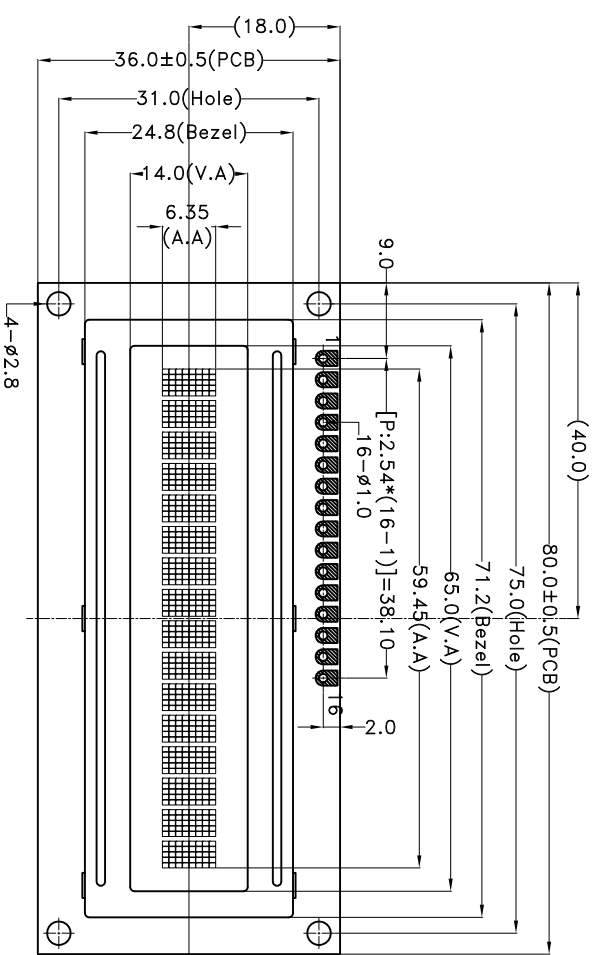

Scale:5/1
Detail:FDOTS

SPECIFICATIONS

1. DISPLAY TYPE:STN Y/G/STN BLUE /STN Positive/Negative
2. DISPLAY RESOLUTION:16*01 CHARACTER
3. LCD DRIVING VOLTAGE:4.15V
4. LOGIC VOL TAGE:5.0V
5. VIEWING DIRECTION:Ø C/CLOCK
6. OPERATING TEMP:0°C -- +50°C
7. STORAGE TEMP:-10°C -- +60°C
8. LCD CONTROLLER / DRIVE:SPIC780D1 (Or Compatible)
9. DRIVE MODE:1/16 DUTY,1/5 BIAS
10. BACKLIGHT:SIDE LED BACKLIGHT
11. REMARK:

PCB PIN ASSIGNMENT:

1	VSS	9	DB2
2	VDD	10	DB3
3	V0	11	DB4
4	RS	12	DB5
5	R/W	13	DB6
6	E	14	DB7
7	DB0	15	BLA
8	DB1	16	BLK

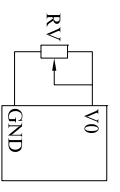

DESCRIPTION:

ThingWell Electronics

SCALE: 1:1	SHEET: 1 OF 1		PROJECTION	LCM NUMBER	W1601A
UNIT: mm	DRAWING VERSION				V01
APP: DATE:	CHK: DATE:	DWN: DATE:			

MECHANICAL TOLERANCE:x.x±0.3,x.xx±0.2